

Multimedia Projector
EB-W29 / EB-97H / EB-945H / EB-955WH / EB-965H

SPECIFICATIONS		EB-W29	EB-97H	EB-945H	EB-955WH	EB-965H	
Projection System		RGB liquid crystal shutter projection system					
Specification of Main Parts	LCD	0.59-inch with MLA (D8)	0.55-inch without MLA (D8)	0.63-inch with MLA (D7)	0.59-inch with MLA (D8)	0.63-inch with MLA (D7)	
Driving Method	Pixel Number	Poly-silicon TFT active matrix					
	Pixel Number	1024,000 dots (1,280 x 800) x 3	786,432 dots (1,024 x 768) x 3		1024,000 dots (1,280 x 800) x 3	786,432 dots (1,024 x 768) x 3	
	Native Resolution	WXGA (16:10)	XGA (4:3)		WXGA (16:10)	XGA (4:3)	
Projection Lens	Type	Manual Focus & 1.2x Optical Zoom F=1.58-1.72 / F=16.9-20.88mm	Manual Focus & 1.2x Optical Zoom F=1.58-1.72 / F=16.9-20.88mm	Manual Focus & 1.6x Optical Zoom F=1.51-1.99 / F=18.2-29.2mm	Manual Focus & 1.6x Optical Zoom F=1.51-1.99 / F=18.2-29.2mm	Manual Focus & 1.6x Optical Zoom F=1.51-1.99 / F=18.2-29.2mm	
	Lens Cover	Slide lens shutter (AV mute slide)					
Lamp	Type	200 W UHE					
	Life	5,000 hours (Brightness Control: Normal) 10,000 hours (Brightness Control: Eco)					
Screen Size (Projected Distance) (Zoom: Wide)		33" to 320" [0.91 to 9.07 m]	30" to 300" [0.89 to 9.12 m]	30" to 300" [0.83 to 8.54 m]	33" to 280" [0.97 to 8.45 m]	30" to 300" [0.83 to 8.54 m]	
Offset		Throw ratio: 1.30	Throw ratio: 1.48	Throw ratio: 1.38	Throw ratio: 1.38	Throw ratio: 1.38	
Light Output*		10:1	8.6:1	8.6:1	10:1	8.6:1	
Normal / ECO		3,000 lm / 2,100 lm	2,700 lm / 1,890 lm	3,000 lm / 2,100 lm	3,200 lm / 2,240 lm	3,500 lm / 2,450 lm	
Color Light Output*		3,000 lm	2,700 lm	3,000 lm	3,200 lm	3,500 lm	
Contrast*		10,000:1					
Color Reproduction		Up to 1.07billion colors					
Sound Output		5W Monaural	16W Monaural				
AV mute		Yes					
Adjustment Function	Vertical Keystone Correction	-30 to +30 degrees (Auto)					
	Horizontal Keystone Correction	-30 to +30 degrees (Slider)					
	Color Temp.	Yes					
	Color Adjustment	Yes					
	Auto Iris	Yes (Dynamic, Theatre only)					
	Quick Corner	Yes					
	Split Screen	Yes					
	E-Zoom	Yes					
	ECO	Power Consumption	Yes (Normal, ECO)				
		Light Optimizer	Yes				
		Sleep Mode	Yes				
		Sleep Mode Timer	Yes				
		AV Mute Timer	Yes				
	Standby Mode	Yes (Communication On, Off)					
	Flip Horizontal		Yes				
		Yes					
Video I/O	IN	Analog	D-sub 15pin	2 (Blue molding)			
			RCA	1 (Yellow)			
			Min DIN 4pin	1			
	Digital	HDMI	1 (not supports MHL)		2 (One of terminal supports MHL)		
Out	Analog	D-sub 15pin	1 (Black molding) (Output signal : Computer 1 only)				
Audio I/O	IN		2 RCA (White x1, Red x1)	1			
			Stereo mini	2			
	Out		Stereo mini	1			
Mic. I/O	IN		Stereo mini	N/A	1		
Control I/O	RS-232C		D-sub 9pin	1			
USB-I/O	Type A	1 (for USB Memory, USB Document Camera, Wireless LAN, Firmware update, Copy OSD Settings)					
	Type B	1 (for USB Display, mouse, K/B, Control, Firmware update, Copy OSD Settings)					
	Wired LAN		RJ45	1			
Network I/O	Wireless LAN	TypeA (ELPAP07:Option)					
	Supported Speeds for each mode	IEEE 802.11b: 11 Mbps* IEEE 802.11g: 54 Mbps* IEEE 802.11n: 130 Mbps*					
	Supported mode	Adhoc, Infrastructure, Access Point					
	Certification	Wi-Fi CERTIFIED (for Projector unit)					
Frequency type (modulations)		802.11b/g/n (2.4GHz) (DSSS/CCK, OFDM)					
		5°C to 35°C <41 °F to 95 °F> (20% - 80% humidity, No condensation)					
Operating Altitude	0 m to 3,000 m <0 ft to 9,843 ft>						
Direct Power Off	Yes						
Start-up Period	about 5 seconds						
Cool-down Period	Instant off						
Exhaust Direction	Front						
Intake Direction	Side						
Air Filter	5,000H (*)						
Power Supply Voltage	Maintenance Cycle	100 - 240 V AC +/- 10%, 50/60 Hz					
Power Consumption	220-240V Area	Lamp On/Energy Saving	273W / 0.26W	287W / 0.26W	287W / 0.26W	287W / 0.26W	
Dimension	Exclude Feet (W x H x D)		297 x 87 x 244 mm		297 x 87 x 269 mm		
Weight			Approx. 5.8 lbs. / 2.6kg		Approx. 6.0 lbs. / 2.7kg		
Fan Noise	Power consumption: Normal / ECO		37 dB / 29 dB				

Light Output / Color Light Output (Compliant with IDMS15.4) / Contrast - Color mode: Dynamic, Zoom: Wide () When used in the general office environment (the amount of floating dust: 0.04-0.2 mg/m³). Based on the Epson's in-house test results.
 *Maximum speed and range is achievable when used with same enhanced mode technology. Actual data rates, features and performance may vary depending on your computer system, the environment and other factors.

Optional Accessories

ELPLP88	Spare Lamp
ELPAP32	Air Filter Set
ELPKS67	Soft Carrying Case
ELPAP07	Wireless LAN Unit
ELPAP09	Quick Wireless Connection USB Key

WARRANTY SERVICE
 2 Years Onsite Warranty Service to be provided for local purchase only.
EPSON COVERPLUS # The warranty service can be extended by purchasing Epson Coverplus Extended Warranty. For more information, please contact Epson customer support.

Bold, Bright, Beautiful...3LCD Technology

3LCD technology achieves bright, natural images and smooth, sharp video playback. No color break-up makes images gentle on eyes.



Optical unit with high light-use efficiency

Supplied Accessories

Power Cable (1.8 m)	Remote Control	Battery
Computer Cable (1.8 m)	Password Protect Sticker (Except EB-W29)	

EPSON EXCEED YOUR VISION
Epson Hong Kong Limited
 Unit 715-723, 7/F Trade Square, 681 Cheung Sha Wan Road, Cheung Sha Wan, Kowloon, Hong Kong

Hong Kong Region:
Epson Authorized Customer Service Centre (Collection Point)
 Room 1003, 10/F, Block B, Sea View Estate, 4-6 Watson Road, North Point

Kowloon Region:
Epson Authorized Customer Service Centre (Repair Service)
 Unit 901, 9/F, Westin Centre, 26 Hung To Road, Kwun Tong

Epson Authorized Customer Service Centre (Collection Point)
 Room 1005-8, 10/F, Park-in Commercial Centre, 56 Dundas Street, Mongkok

New Territories Region:
Epson Authorized Customer Service Centre (Collection Point)
 Unit 7, 21/F, CCT Telecom Building, 11 Wo Shing Street, Fo Tan

Sales hotline : (852) 2827 8711
 Technical hotline : (852) 2827 8911

URL: www.epson.com.hk

Please call our sales hotline for demonstration at our showroom

DEC14-01-PROJECTOR

Multimedia Projector
EB-W29 EB-955WH
EB-97H EB-965H
EB-945H

EPSON
 EXCEED YOUR VISION



Make the classroom a fun place to be with more effective lessons

Multimedia Projector

EB-W29 EB-97H EB-945H EB-955WH EB-965H



Easy and flexible usability

Contrast Ratio

With a stunningly bright 3500 lumens* and a 10000:1 contrast ratio you can project beautiful well-defined images wherever you are, regardless of ambient light. (*EB-965H only)

3500lm
Color Light Output
10000:1
contrast



1.6x Zoom Lens (EB-945H / 955WH / 965H)

The wide 1.6x zoom lens allows for greater flexibility of placement around the room.



Front Exhaust

The front exhaust helps to direct the hot exhaust away from your audience for more comfortable meetings and presentations with less distraction.



Horizontal Keystone Adjuster

The Horizontal Keystone Adjuster allows for intuitive horizontal keystone correction. This convenient adjustment feature corrects image distortion with a single touch for a broad range of placement options. Images can be enjoyed quickly and beautifully anywhere you choose.

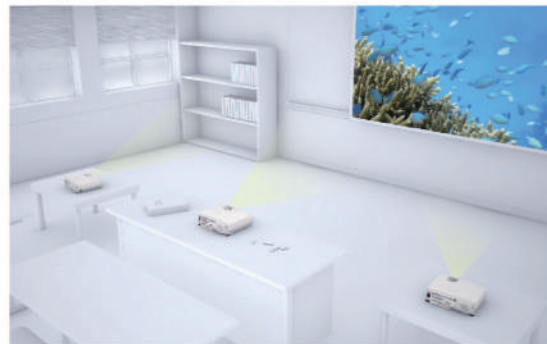

Enhanced Audio

16W Built-in Speaker (EB-97H / 945H / 955WH / 965H)

The built-in 16W speaker provides ample sound even in large rooms and removes the need to prepare external speakers, saving both valuable time and money. It also supports audio standby with which both internal speaker and audio output. With the audio standby function, the internal speaker can be operated even the projector is switched off.



Auto Power On

Projection starts automatically when a signal from the computer is received while the projector is in standby. There is no need to turn on the power using the remote control or the power button on the projector itself.



Advanced operation with wider connectivity

Wide-ranging Connectivity (MHL is only available in EB-97H / 945H / 955WH / 965H)

Depending on the situation, you can choose from a variety of connection methods including HDMI, VGA and LAN. Furthermore, it is now equipped with 2 HDMI ports (the HDMI 2 port is MHL compatible) for more complete digital compatibility.



Wireless Connection

You can transfer images easily with the optional ELPAP07 wireless module. Also, using the "Epson iProjection" application allows you to display images and files from your smart devices. This is a convenient solution for smooth and smart projection.

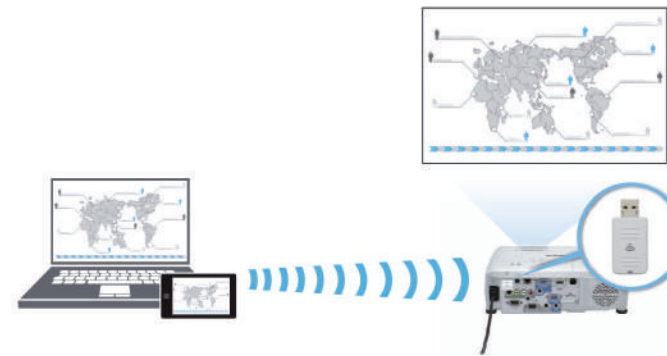

Improved Multi PC Projection

The Multi PC Projection feature allows a network of up to 50 PCs to be connected to a single projector. The newest version of this feature allows a host PC to act as a Moderator who can then select up to 4 of these connected computers and project their screens. The addition of a Moderator helps to maintain control and prevents tampering with the projected screen.

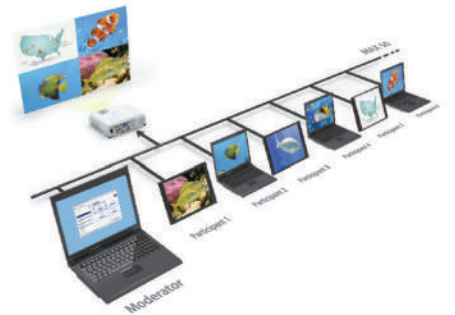

Firmware Update via USB & Network

Firmware updates can now be done on site by simply inserting a USB memory stick with the necessary updates. This means the update can be done with the projector still installed without having to take it to a service center and rendering it unusable. Updates can also be done over a LAN network or via USB-B connection.



Direct Connection with Document Camera

A direct connection with document cameras makes set-up quick and easy with less preparation necessary.



Low TCO

Long Lamp Life 10000h

The long 10000H lamp life saves time and money by reducing the frequency of costly lamp replacements. However, when a lamp does require changing it can be done quickly and easily even in ceiling mounted applications.



Split Screen

Split Screen allows inputs from two separate sources to be displayed side by side on the same screen. For example, images from a document camera and an electronic textbook could be projected at the same time.

